

- 1 Generator
- 2 Conex Boxes (Storage)
- 3 Fuel ASTs
- 4 Fire Stations, Air Horns & Site Maps
- 5 Trash (offsite generated)
- 6 Scrap Metal Roll Off Box
- 7 Porta Pottys
- 8 Hand Wash Stations
- 9 First Aid Station
- 10 Dress Out Tent & Emergency Shower
- 11 Fire Extinguisher Shipping Pad
- 12 Semi-Tractor Trailer (not used)
- 13 T and D Office
- 14 Oil Base Paint Roll Off Box
- 15 Latex Paint Roll Off Box
- 16 Decon Pad
- 17 Evacuation Route
- 18 Ammo Storage

Orleans Parish HHW Collection Processing Area

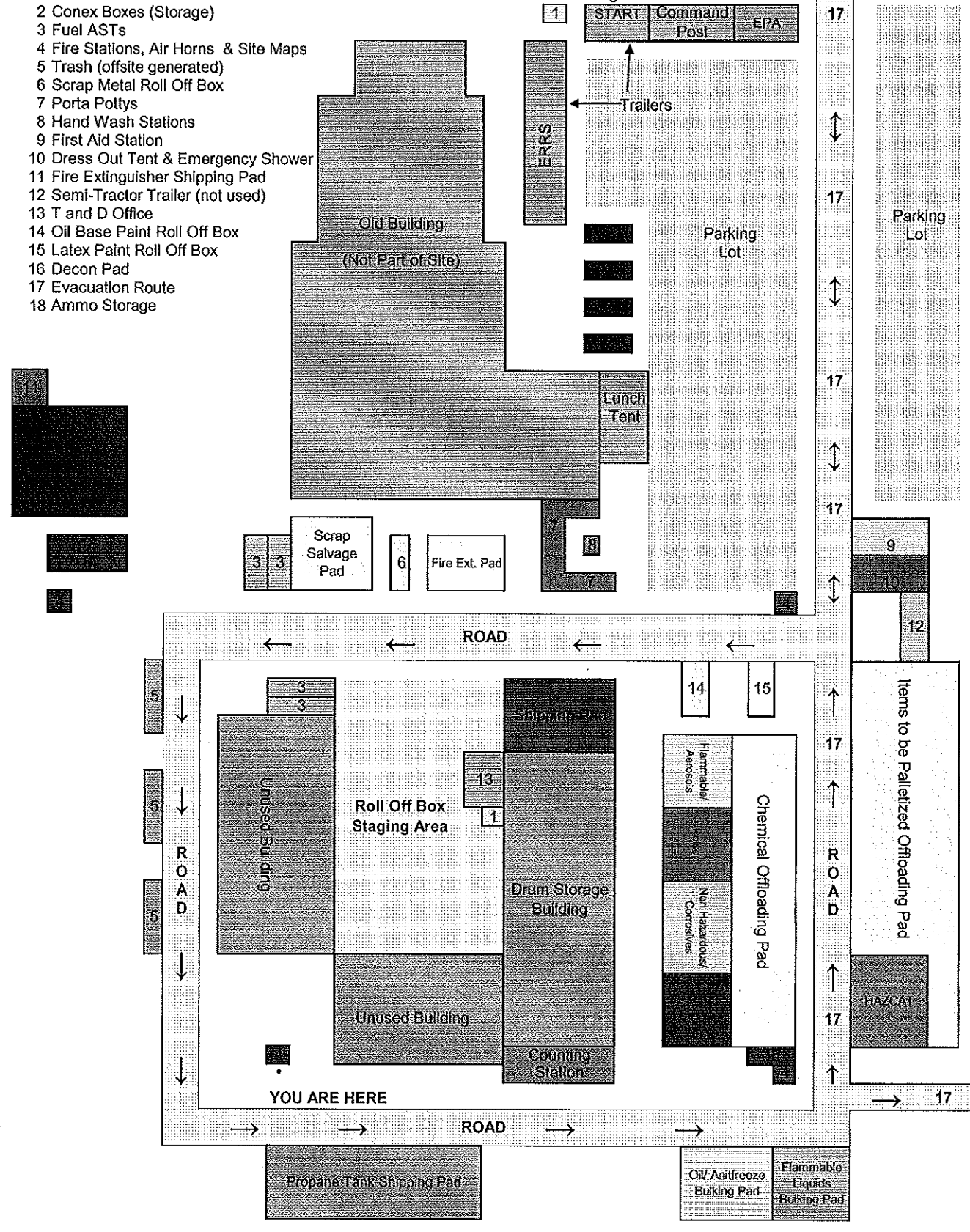

Note: The size of the Waste Collection Pad will depend primarily on 2 factors: 1) Availability of vacant land; and 2) The size of the Disaster Event itself. The Map above depicts the Orleans Parish Waste Collection Pad for the Hurricane Katrina Project and was 3.5 acres in size. The sizes (in acres) of the other Parish Waste Collection Pads were as follows: St. Tammany - 4; Upper Jefferson - 3; Lower Jefferson (Grand Isle) - 1.5; Plaquemines - 8; St. Bernard - 3; Vermillion - 2. The Plaquemines Parish Waste Collection Pad was considerably larger than any of the other Pads, due to the large numbers of Orphaned Containers and 55-gallon drums recovered.